

8 Install Floppy/CD-ROM/DVD-ROM Backplane Accessory Kit (optional)

The Floppy Drive / CD-ROM Drive / DVD-ROM Drive Backplane accessory kit is required if you want to install one or more of these drive types into your Server Chassis SR1350-E.

Follow the instructions included with your accessory kit to complete the floppy drive / CD-ROM drive or DVD-ROM drive installation.

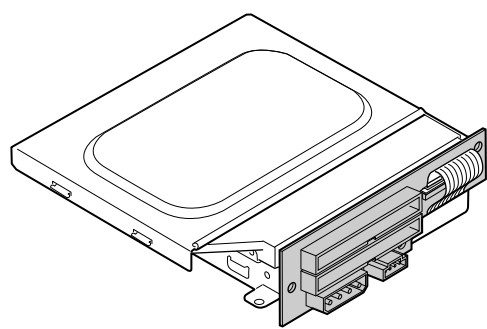

Accessories and Order Codes	
Floppy / CD-ROM / DVD-ROM Drive Backplane Kit	AKACDFLOPPY
Chassis Fans[2], FP bd, FP cbl, Air Duct, PCI Riser Card, I/O Shield & Gaskets[2], ATA Cable	FPAPMKIT
350W Power Supply	FXXCBL350K

A complete list of accessories and spares can be found at: www.intel.com/go/serverbuilder

Fastener Identification Guide

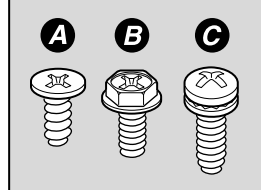

9 Make System Fan Connections

Refer to your server board documentation for the location of server board fan headers and follow the steps below:

- 1 Connect each back panel fan to the nearest system fan header on the server board.
- 2 The fans on the front fan module are numbered from 1 - 5, from right to left (fan 1 is at the far right). Connect fan 1 to the CPU 1 fan header. Connect fan 3 to the CPU 2 fan header. Connect the remaining fans to the nearest system fan headers.

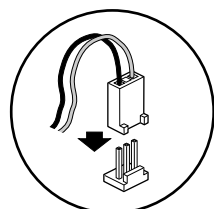
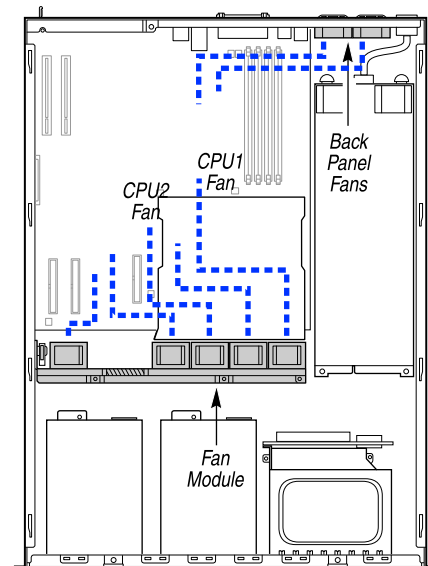

Use cable ties as needed.

10 Install Processor Air Duct

Processor Air Duct Front Edge

The processor air duct is required for proper airflow within your chassis.

Install the processor air duct as shown. The front edge should contact the fan module and the top of the air duct should be flush with the top of the power supply.

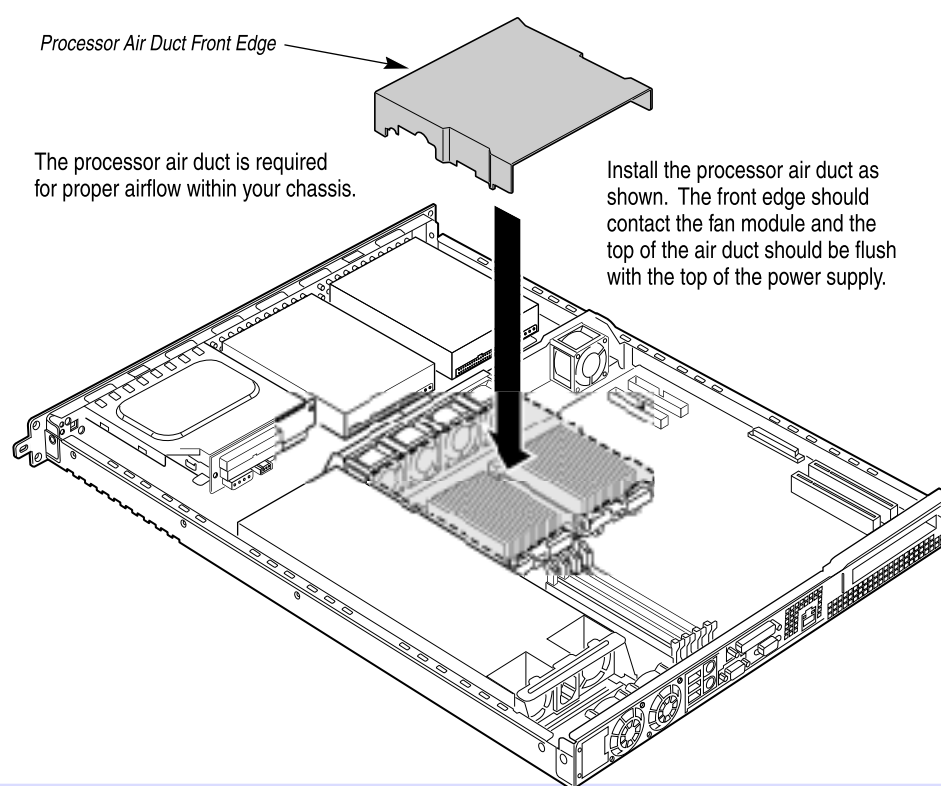

11 Connect Drive Power and Front Panel Board

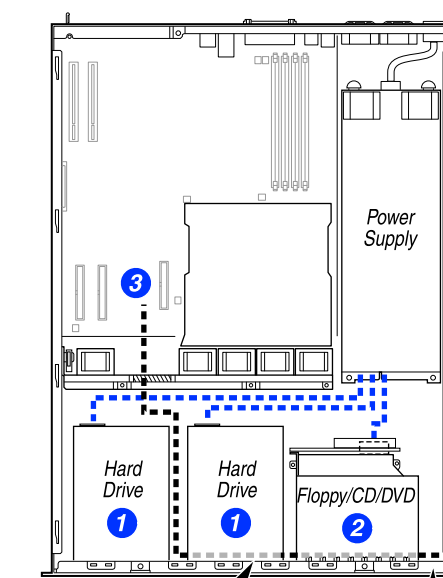

- 1 Connect a power cable from the power supply to both hard disk drives.
- 2 If you installed the floppy / CD-ROM / DVD-ROM backplane kit, connect a power cable from the power supply to the floppy / CD-ROM / DVD-ROM backplane board.
- 3 Connect the front panel cable as shown. See your server board documentation for the location of the front panel connector.

Note: Make sure cabling does not restrict air flow to any of the fans.

Use cable ties as needed.

Make sure front panel cable is routed underneath hard drive and floppy / CD-ROM / DVD-ROM module.

Front Panel Board

12 Make Server Board Power Connections

Refer to your server board documentation for location and number of server board power connectors and follow the steps below:

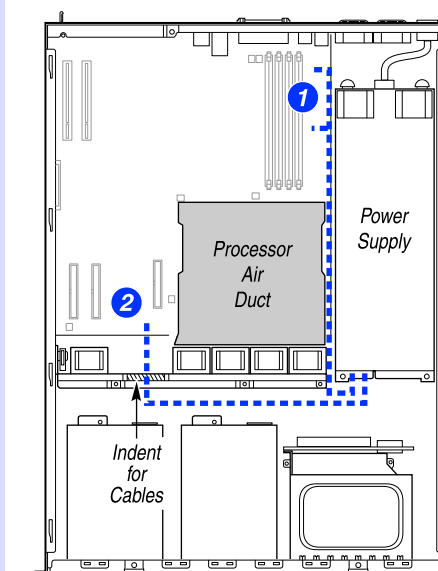

- 1 For power connections to this location on the server board, cables must be routed between the processor air duct and the power supply as shown.
- 2 For power connections to this location on the server board location, cables must be routed in front of the fan module and over the indent on the fan module bracket.

Note: Use caution not to pinch cables and ribbons, and make sure cabling does not restrict air flow from any of the fans.

Use cable ties as needed.

13 Make Data Cable Connections

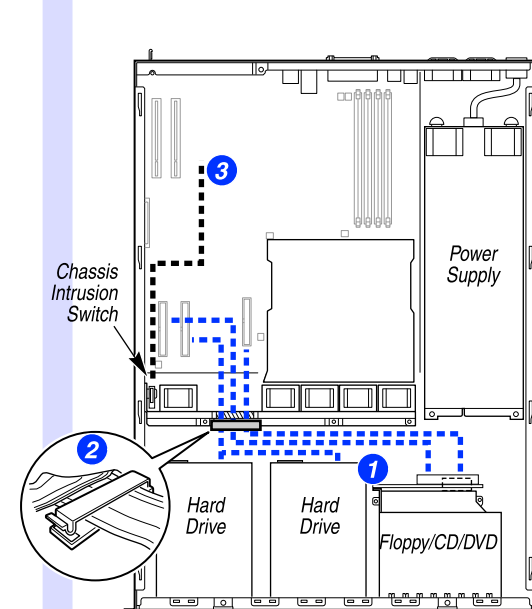

Notes: Not all chassis/server board combinations provide all IDE or SCSI data ribbon cables you may need for your particular configuration.

Use cables of appropriate length and fold cables to lay flat.

Use caution to avoid pinching cables and ribbons, and make sure cabling does not restrict air flow from any of the fans.

See your server board documentation for connection locations.

- 1 Attach data cables between all drives and the server board.
- 2 Install cable clamp in front of fan module as shown. The clamp should contain all ribbons and cables that are routed over the indent in the fan bracket. When closing clamp, use caution to avoid pinching cables and ribbons.
- 3 Connect chassis intrusion cable to server board.

14 Install Add-in Card

Some server boards have a PCI riser connector. Locate your riser and install the add-in card as shown.

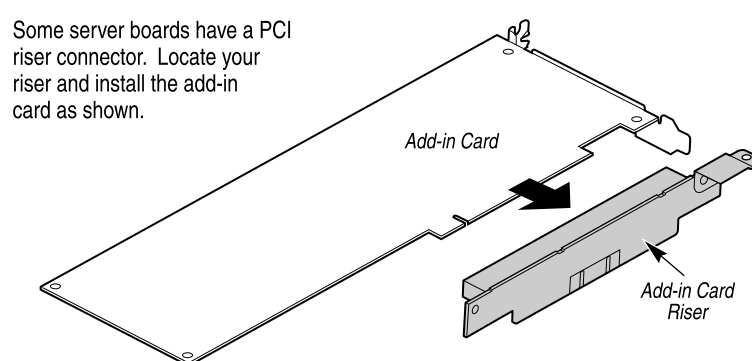

16 Install Rackmount Handles

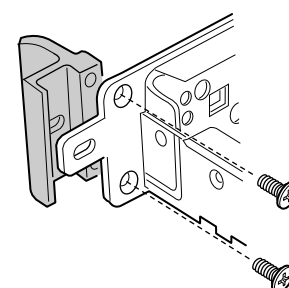

The rackmount handles were shipped to you with the screws inserted into the handles.

- 1 Remove the screws from the handles.
- 2 Position the handles at each side of the chassis and reinsert the screws through the sheetmetal and into the handles.

15 Install Riser/Add-in Card Assembly

The riser/add-in card assembly installs as shown. Firmly seat the riser into the server board connector and attach with screw.

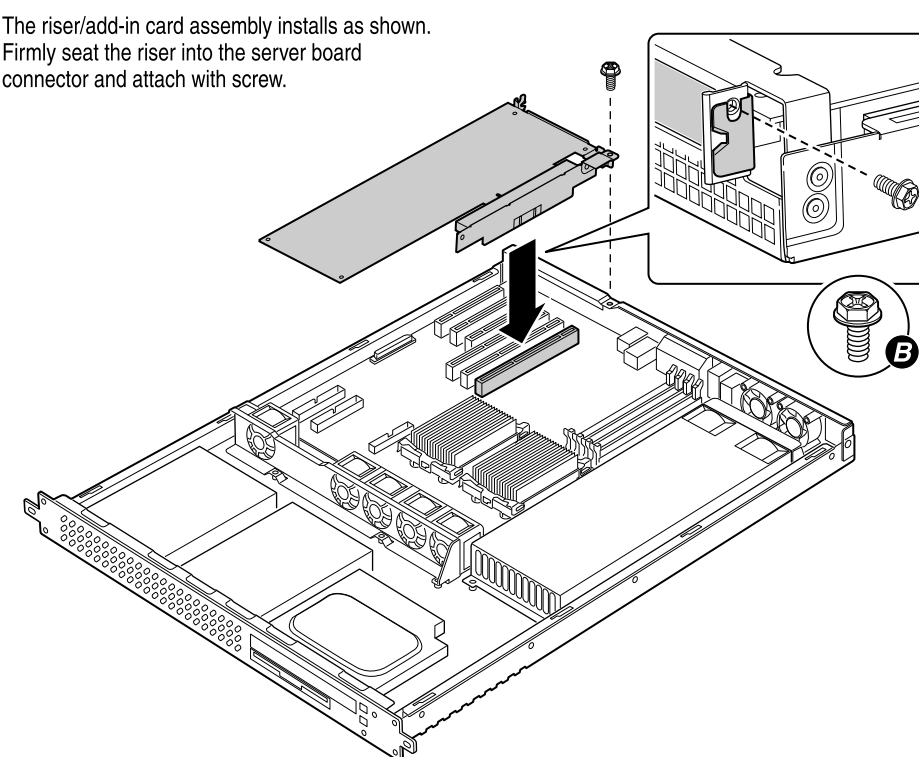

17 Front Panel Controls and Indicators

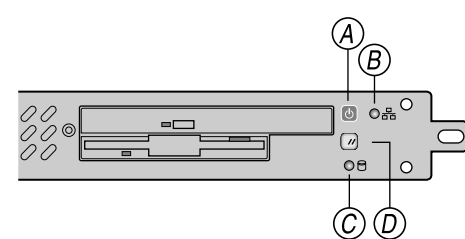

- A System Power Button and LED
- B Network Activity LED
- C Hard Disk Drive Indicator LED
- D Reset Button

18 Finishing Up

Before installing your operating system, you must finish your chassis installation and connect back panel I/O connectors and AC power. Your server board back panel I/O ports may differ. See your server board documentation for further information.

- 1 Replace the chassis cover.
- 2 See your chassis product guide to complete rack or pedestal installation.
- 3 Connect your keyboard, mouse, video and other I/O cables as shown. Connect the AC power cable last.

CAUTION: This unit must be operated with the top cover installed to ensure proper cooling.