

Intel® Server Chassis SR1350-E Quick Start User's Guide



Start Here

Thank you for buying an Intel® Server Chassis. The following information will help you prepare your server chassis for integration with your selected server board.

This guide is for technically qualified persons. Expanded installation instructions and complete product information are available in the product guide at <http://support.intel.com/support/motherboards/server/chassis/SR1350-E>.

Before you begin

You will need the following tools and equipment:

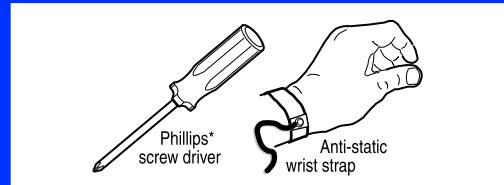

See your product guide and the *Intel Server Boards and Chassis Safety Information* document at <http://support.intel.com/> for product safety and EMC regulatory compliance information.

If you are not familiar with ESD (Electro-Static Discharge) Procedures to be used during system assembly, complete ESD Procedures are described in your *Product Guide*.

Build Value with Intel

Server Products, Programs and Support
Get the high-value server solutions you need by taking advantage of the outstanding value Intel provides to system integrators:

- High-quality server building blocks
- Extensive breadth of server building blocks
- Solutions and tools to enable e-Business
- Intel® Server Management
- Comprehensive training services¹
- Worldwide 24x7 technical support (AT&T Country Code + 866-655-6565)¹
- World-class service, including a three-year limited warranty and Advanced Warranty Replacement¹

For more information on Intel's added-value server offerings, visit the Intel® ServerBuilder website at: www.intel.com/go/serverbuilder

Intel ServerBuilder is your one-stop shop for information about all of Intel's Server Building Blocks such as:

- Product information including product briefs and technical product specifications
- Sales tools such as videos and presentations
- Configurator Tools to help you build complete solutions
- Training information such as the Intel® Online Learning Center
- Support Information and much more

¹Available only to Intel® Channel Program Members, part of Intel® e-Business Network.

1 Remove the Top Cover

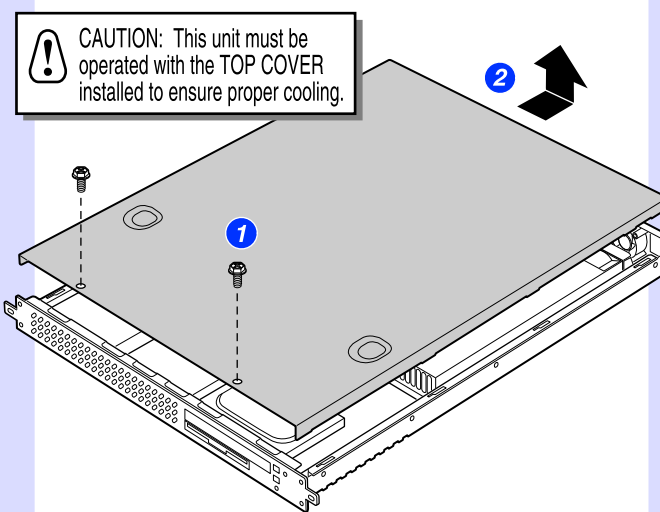

To remove the system top cover:
1 Remove two screws.
2 Slide toward rear and lift upward.

Fastener Identification Guide

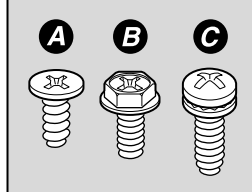

2 Install the Hard Disk Drives

A Remove the Hard Drive Carrier Bracket

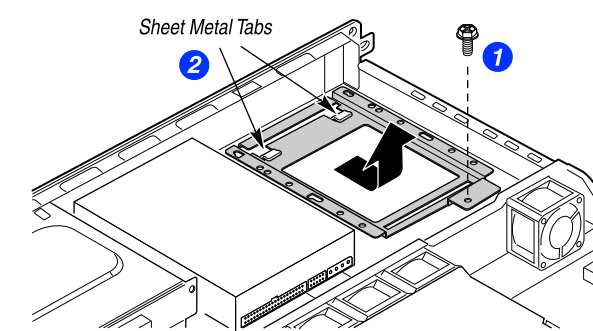

To remove the system top cover:
1 Remove screw.
2 Slide toward rear to disengage two metal tabs and lift upward.

B Install Hard Drive to Bracket

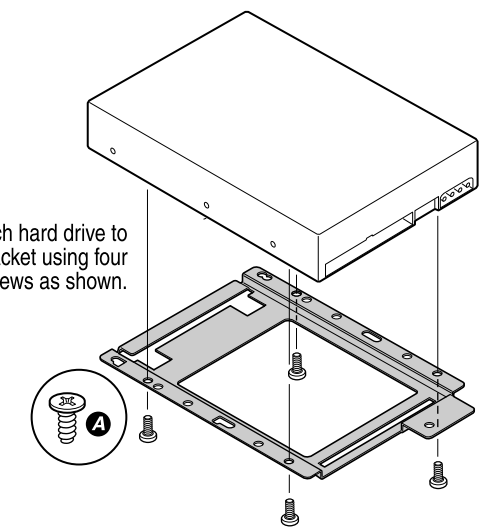

C Re-install Hard Drive/Bracket Assembly

Prior to installing your drive assemblies, consider the following:

Some hard disk drives need to be configured during installation in order to work properly in your server system.

- 1 If you are installing IDE drives, one must be configured as a "master" drive, and the other as a "slave". See your drive documentation for additional information.
- 2 If you are installing SCSI drives, see your drive documentation for assigning device ID numbers.

3 Select and Install the Back Panel I/O Shield

Two I/O shields are included with your chassis. Match the I/O shield to the I/O ports on your server board to determine the correct shield to install.

Install the shield from the inside of the chassis. Insert the top edge first to engage the two tabs at the top of the I/O shield to the top edge of the chassis. Rotate the shield downward and press it firmly into the back panel opening.

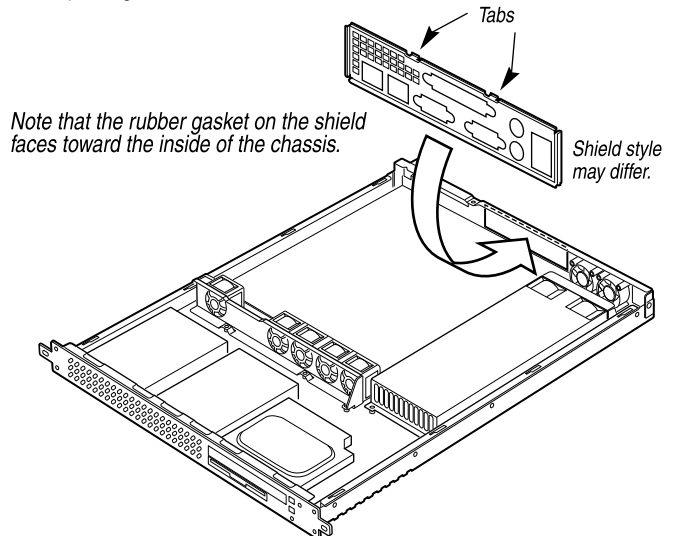

4 Install the Server Board

NOTES: Connectors located at the left edge of the server board may not be accessible after installing the board into the chassis. Make these connections *before* inserting your server board into the chassis. See your server board documentation for connection identification.

Your chassis was shipped with an insulating pad inserted in the area where the server board is to be placed. This pad prevents the bottom surface of the server board from contacting the metal surface of the chassis. **Make sure the insulating pad is in place before inserting your server board.**

Install server board by inserting the left edge first, then lower the board and slide it rearward to engage the I/O shield openings. Note that chassis has shouldered standoffs to aid in aligning the server board.

Install screws into all available mounting holes that have matching standoffs. Your server board may include a mounting hole that does not match a standoff. If so, do not insert a screw into this mounting hole.

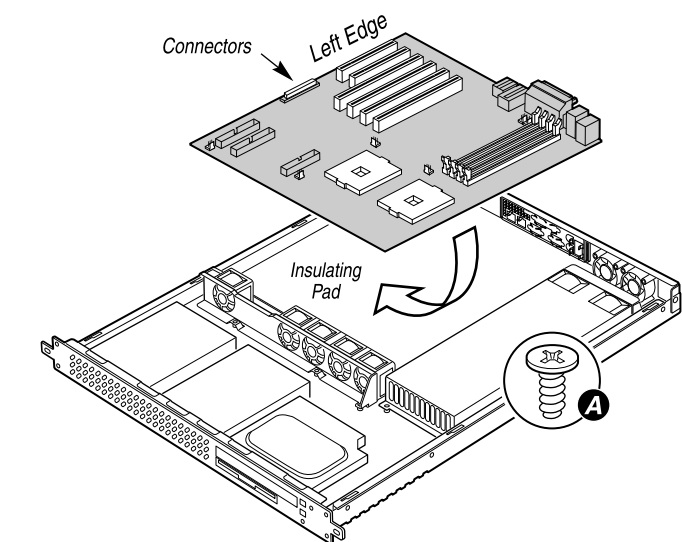

Go to SIDE 2

6 Install Processor Socket 2 Air Dam (if required)

If you have installed only ONE processor onto a server board that contains two processor sockets, complete this step to maintain proper system airflow. If you have installed two processors or if your server board contains only one processor socket, skip this step.

A Install the Processor Retention Devices

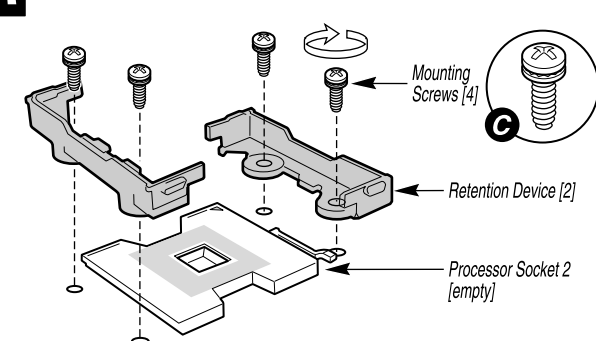

B Install the Air Dam

- 1 Install air dam by inserting into retention devices as shown.
- 2 Insert tabs on air dam under sides of retention device.

Note that air dam bends upward when installed correctly.

See your server board documentation for location of socket 2

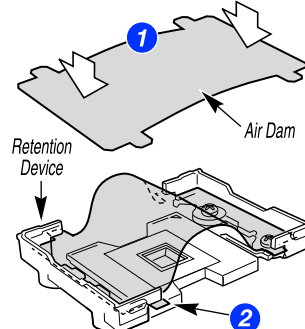

7 Install Memory

Depending upon which server board you have installed, DIMM install sequence and type may differ. See your *Server Board Documentation* for additional DIMM specifications and procedures.

Avoid touching gold contacts when handling or installing DIMMs.

- 1 Open both DIMM Socket Levers.
- 2 Insert DIMM making sure the connector edge of the DIMM aligns correctly with the socket slot.
- 3 Check that socket levers are securely latched.

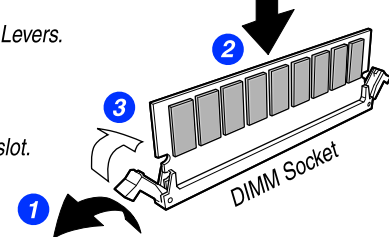

5 Install the Processor[s]

Notes and Cautions:

1. If only ONE processor is to be used, it must be installed in the Processor Socket 1.
2. Do not mix processors of different types or frequencies.
3. When unpacking a processor, hold by the edges only to avoid touching the pins.
4. This server board has "zero-insertion force" sockets. If processor does not drop easily into socket holes, make sure lever is in the full-open position.

A Install the Processor Retention Devices

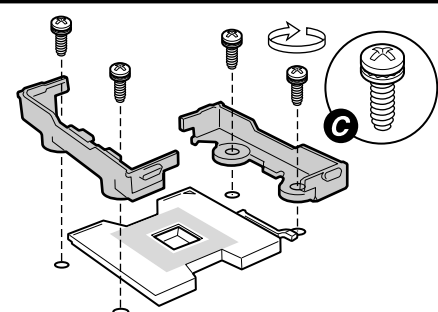

B Open the Socket Lever

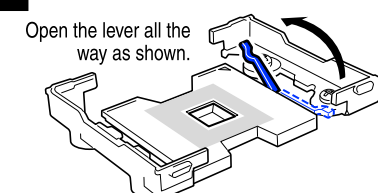

C Install the Processor

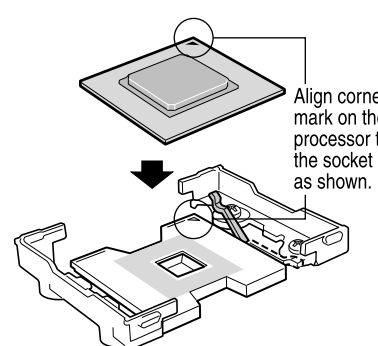

D Close the Socket Lever

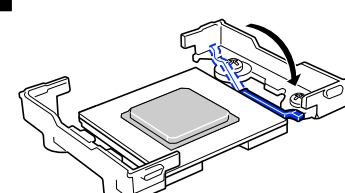

E Install the Heat Sink

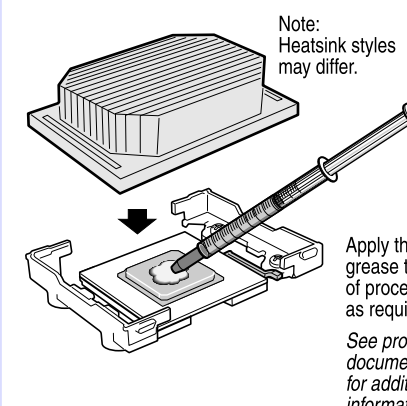

WARNING: Installation and service of this product to be performed only by qualified service personnel to avoid risk of injury from electrical shock or energy hazard.

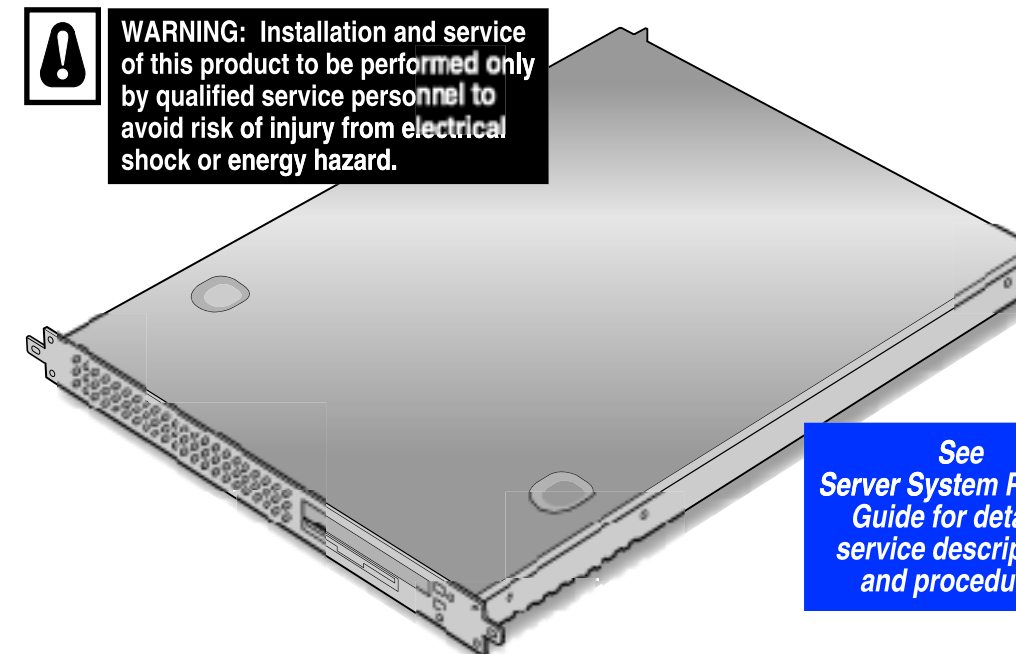

See *Server System Product Guide* for detailed service descriptions and procedures.

