

10 9 8 7 6 5 4 3 2 1

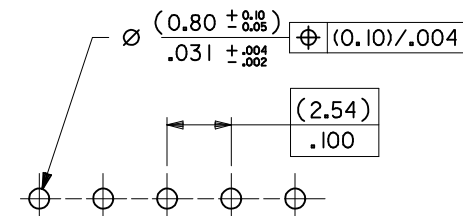

RECOMMENDED P.C. BOARD
HOLE PATTERN
FOR STRAIGHT PINS.

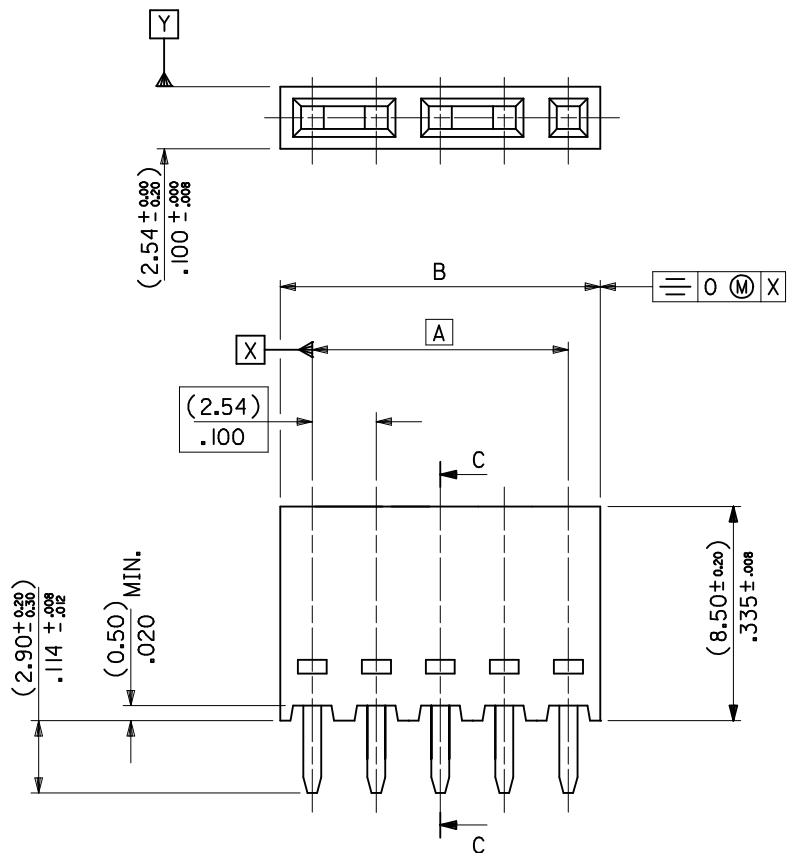
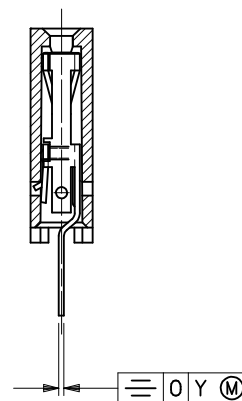

SECTION C-C SHOWING
STRAIGHT PINS.

NOTES:

- 1) CONTACT-PLATED PHOSPHOR BRONZE.
- 2) HOUSING-15% GLASS FILLED POLYESTER.
COLOUR: BLACK.
- 3) FOR (0.635)/.025 SQ. MALE PINS THE LENGTH
MUST BE (5.65)/.222 MIN & (7.00)/.276 MAX. TO
ENSURE GOOD CONNECTION WITH CONTACT.
- 4) PRODUCT SPECIFICATION: PS-99020-0001
- 5) PCB THICKNESS 1.6MM

| | | | | | | | | | | | |
|---|--|-------------|----------------------|--------------------------------------|--|--|--------------------------|--|---|--------------|---------------------------|
| ADDED GATE AREA EC NO: E2009-0250 2008/12/08 DRWN:BMAGUIRE 2008/12/08 CHKD: 2008/12/08 APPR:BMAGUIRE 2008/12/08 | | | | QUALITY SYMBOLS ▽=0 ◻=0 | GENERAL TOLERANCES (UNLESS SPECIFIED) | | DIMENSION STYLE | | SCALE | DESIGN UNITS | THIRD ANGLE PROJECTION |
| | | | | | | | MM/IN | | 1:1 | METRIC | |
| | | | | | | | DRAWN BY DATE | | TITLE C-GRID III, SINGLE ROW VERTICAL P.C. BOARD CONNECTOR ASSEMBLY. | | |
| | | | | | | | DB 1987/07/14 | | | | |
| AC | | DESCRIPTION | 4 PLACES ± --- ± --- | | CHECKED BY DATE | | MOLEX MOLEX INCORPORATED | | | | |
| | | | 3 PLACES ± --- ± --- | | JDENNEHY 2005/07/07 | | | | | | |
| | | | 2 PLACES ± --- ± --- | | APPROVED BY DATE | | | | | | |
| | | | 1 PLACE ± --- ± --- | | JDENNEHY 2005/07/07 | | | | | | |
| DRAFT WHERE APPLICABLE MUST REMAIN WITHIN DIMENSIONS | | REV | ANGULAR ± 2 ° | | MATERIAL NO. | | DOCUMENT NO. | | SHEET NO. | | |
| | | | SEE SHEET 2 | | SDA-90147 | | 1 OF 2 | | | | |
| | | | | | THIS DRAWING CONTAINS INFORMATION THAT IS PROPRIETARY TO MOLEX INCORPORATED AND SHOULD NOT BE USED WITHOUT WRITTEN PERMISSION | | | | | | |
| | | | | | | | | | | | |

9 8 7 6 5 4 3 2 1

| | 10 | 9 | 8 | 7 | 6 | 5 | 4 | 3 | 2 | 1 | |
|---|---------------------------|-------------------|---------------|-----------------|-------------------------------|------------------|---|---|---|---|--|
| F | PART NO'S - STRAIGHT PINS | | NO.OF CKTS | DIM." A" | DIM." B" (+0.00) -0.012 | QTY. PER TUBE | | | | | |
| | STANDARD | CUSTOMER SPECIFIC | | | | | | | | | |
| | 90147-1X02 | | 2 | (2.54) .100 | (5.08) .200 | 105 | | | | | |
| | ↑ 03 | | 3 | (5.08) .200 | (7.62) .300 | 72 | | | | | |
| | 04 | | 4 | (7.62) .300 | (10.16) .400 | 52 | | | | | |
| | 05 | 90147-9105 | 5 | (10.16) .400 | (12.70) .500 | 44 | | | | | |
| | 06 | | 6 | (12.70) .500 | (15.24) .600 | 36 | | | | | |
| | 07 | | 7 | (15.24) .600 | (17.78) .700 | 30 | | | | | |
| | 08 | | 8 | (17.78) .700 | (20.32) .800 | 26 | | | | | |
| | 09 | | 9 | (20.32) .800 | (22.86) .900 | 22 | | | | | |
| | 10 | | 10 | (22.86) .900 | (25.40) 1.000 | 22 | | | | | |
| | 11 | | 11 | (25.40) 1.000 | (27.94) 1.100 | 20 | | | | | |
| | 12 | | 12 | (27.94) 1.100 | (30.48) 1.200 | 18 | | | | | |
| | 13 | | 13 | (30.48) 1.200 | (33.02) 1.300 | 16 | | | | | |
| | 14 | | 14 | (33.02) 1.300 | (35.56) 1.400 | 14 | | | | | |
| | 15 | | 15 | (35.56) 1.400 | (38.10) 1.500 | 14 | | | | | |
| | 16 | | 16 | (38.10) 1.500 | (40.64) 1.600 | 13 | | | | | |
| | 17 | | 17 | (40.64) 1.600 | (43.18) 1.700 | 13 | | | | | |
| | 18 | | 18 | (43.18) 1.700 | (45.72) 1.800 | 12 | | | | | |
| | 19 | | 19 | (45.72) 1.800 | (48.26) 1.900 | 12 | | | | | |
| | 20 | | 20 | (48.26) 1.900 | (50.80) 2.000 | 11 | | | | | |
| | 21 | | 21 | (50.80) 2.000 | (53.34) 2.100 | 11 | | | | | |
| | 22 | | 22 | (53.34) 2.100 | (55.88) 2.200 | 10 | | | | | |
| | 23 | | 23 | (55.88) 2.200 | (58.42) 2.300 | 9 | | | | | |
| | 24 | | 24 | (58.42) 2.300 | (60.96) 2.400 | 9 | | | | | |
| | 25 | | 25 | (60.96) 2.400 | (63.50) 2.500 | 8 | | | | | |
| | 26 | | 26 | (63.50) 2.500 | (66.04) 2.600 | 8 | | | | | |
| | 27 | | 27 | (66.04) 2.600 | (68.58) 2.700 | 8 | | | | | |
| | 28 | | 28 | (68.58) 2.700 | (71.12) 2.800 | 7 | | | | | |
| | 29 | | 29 | (71.12) 2.800 | (73.66) 2.900 | 7 | | | | | |
| | 30 | | 30 | (73.66) 2.900 | (76.20) 3.000 | 7 | | | | | |
| | ↓ 31 | | 31 | (76.20) 3.000 | (78.74) 3.100 | 7 | | | | | |
| | 90147-1X 32 | | 32 | (78.74) 3.100 | (81.28) 3.200 | 6 | | | | | |

PLATING VERSION A

PRE-PLATED HOT DIP TIN

1.0 TO 2.5 um (.000040" TO .000100").

PLATING VERSION E

1.27 TO 1.78 um (.000050" TO .000070") NICKEL

OVERALL, 0.38 TO 0.64 um (.000015" TO .000025")

GOLD ON CONTACT AREA (OVER NICKEL).

3 TO 5 um (.000120" TO .000200") TIN

ON SOLDER TAILS (OVER NICKEL).

PLATING VERSION F.

1.27 TO 1.78 um (.000050" TO .000070") NICKEL

OVERALL, 0.76 TO 1.0 um (.000030" TO .000040")

GOLD ON CONTACT AREA (OVER NICKEL).

3 TO 5 um (.000120" TO .000200") TIN

ON SOLDER TAILS (OVER NICKEL).

90147-XXYY

INDICATES NO. OF CIRCUITS.

PLATING CODE.

1 = VERSION A.

2 = VERSION E.

3 = VERSION F.

SEE CHART.

STANDARD PRODUCTS

| | | | |
|--|------------|-------------|-----------------|
| REMOVE PLATING OPTION 4 AS PER GCN#10502698 EC NO: S2012-0718 DRAWN: TSEE CHKD: SKANG APPR: MLONG | 2012/03/20 | 2012/04/09 | 2012/04/09 |
| | DRW | CHK | APP |
| AB | REV | DESCRIPTION | QUALITY SYMBOLS |
| | | ▽=0 | |
| | | ▽=0 | |

GENERAL TOLERANCES
(UNLESS SPECIFIED)

| | mm | INCH |
|----------|-------|-------|
| 4 PLACES | ± --- | ± --- |
| 3 PLACES | ± --- | ± --- |
| 2 PLACES | ± --- | ± --- |
| 1 PLACE | ± --- | ± --- |

ANGULAR ± 2 °

DRAFT WHERE APPLICABLE
MUST REMAIN
WITHIN DIMENSIONS

DIMENSION STYLE
MM/IN

| | |
|--------------|------------|
| DRAWN BY | DATE |
| DB | 1986/12/28 |
| CHECKED BY | DATE |
| JDENNEHY | 2005/07/07 |
| APPROVED BY | DATE |
| JDENNEHY | 2005/07/07 |
| MATERIAL NO. | |

SCALE
NTS

DESIGN UNITS
METRIC

THIRD ANGLE
PROJECTION

C-GRID III SINGLE ROW
VERTICAL P.C. BOARD
CONNECTOR



MOLEX INCORPORATED

SEE TABLE

DOCUMENT NO.
SDA-90147

SHEET NO.
2 OF 2

SIZE
A3

THIS DRAWING CONTAINS INFORMATION THAT IS PROPRIETARY TO MOLEX
INCORPORATED AND SHOULD NOT BE USED WITHOUT WRITTEN PERMISSION