



# COMANCHE® 3

## TECHNICAL SUPPLEMENT

### PROGRAMMABLE JOYSTICK FILES (Addition)

*Comanche 3* comes with pre-programmed downloadable files for ThrustMaster and CH joysticks and throttles. These files allow you to instantly set-up the functionality of certain joysticks, throttles, or both in combination. To use these files, you must first copy them from the *Comanche 3* CD and place them in the appropriate joystick/throttle directory (i.e. C:\PROTHROT or C:\MARK2\PROGRAMS) on your hard drive. These files are stored in three separate sub-directories: *Joystick* (containing joystick files only), *Throttle* (containing throttle files only), and *Both* (which contains files used for joystick and throttle combinations.)

#### 1. Copying Joystick/Throttle Files using Windows® 95

- Copying pre-programmed joystick/throttle files from your *Comanche 3* CD to your hard drive using Windows'95 is easy. Just follow these simple instructions.
- Use your Windows Explorer program to access the CD ROM drive. Assuming your CD ROM drive is *D:*, click on the CD icon which reads *Comanche 3 (D:)*. This will open the *Comanche 3* CD and display all its files in the window to the right.
- Open the folder labeled *Joystick* by double-clicking on joystick folder icon. Inside you will find two sub-folders labeled *CH* and *Thrust*. (*CH* stands for CH™ products and *Thrust* stands for ThrustMaster® products.)
- Open the appropriate folder. Inside you will find three additional folders labeled *Joystick*, *Throttle*, and *Both*. If you are using a joystick, open the folder labeled *Joystick*. If you are using a throttle, open the folder labeled *Throttle*. If you are using both, open the folder labeled *Both*.
- Within each of these sub-folders (*Joystick*, *Throttle*, *Both*) are additional directories containing the pre-programmed files. Refer to the diagrams below for the complete pathname of your configuration. (For example, if

you are using the ThrustMaster' FCS and the ThrustMaster' WCS in combination, you would open the folder labeled FCSWCS. Inside are two pre-programmed files labeled *C3.adv* and *C3.mdf*).

- Open the desired directory and use your mouse to click and drag the necessary file(s) over to the appropriate folder on your hard drive (i.e. C:\PROTHROT or C:\MARK2\PROGRAMS).
- Once you have copied the necessary file(s) to your hard drive, follow the instructions below on downloading the file into your joystick or throttle.

## 2. Copying Joystick/Throttle Files using DOS (and Windows™ 3.1)

- Copying pre-programmed joystick/throttle files from your *Comanche 3* CD to your hard drive using DOS is quick and easy. (If you are running Windows' 3.1, you must exit to DOS before proceeding.)
- From the DOS command line, switch to your CD ROM drive. Assuming your CD ROM drive is D:, at the C:> prompt type: *D: <and press Enter>*
- There is a sub-directory labeled *Joystick*. To access this directory, at the *D:>* prompt, type: *cd joystick*
- Inside the *joystick* sub-directory there are two joystick/throttle sub-directories labeled *CH* and *Thrust*. (*CH* stands for CH' products and *Thrust* stands for ThrustMaster' products.)
- To access these directories at the *D:\joystick>* prompt, type: *cd Ch* or *cd Thrust*.
- Inside you will find three additional directories labeled *Joystick*, *Throttle*, and *Both*. If you are using a joystick, change to the directory labeled *Joystick* by typing *cd joystick*. If you are using a throttle, change to the directory labeled *Throttle* by typing *cd throttle*. If you are using both, change to the directory labeled *Both* by typing *cd both*.
- Within each of these sub-directories (*Joystick*, *Throttle*, *Both*) are additional sub-directories containing the pre-programmed files. Refer to the diagrams below for the complete pathname of your configuration. (For example, if you are using the ThrustMaster' FCS and the ThrustMaster' WCS in combination, you would change to the sub-directory labeled FCSWCS. Inside are two pre-programmed files labeled *C3.adv* and *C3.mdf*)
- Copy this file to the appropriate hard drive directory by typing:  
*copy <filename> C:\<name of directory on your hard drive>* (i.e. C:\PROTHROT or C:\MARK2\PROGRAMS). Press Enter. You will see a message which states: *1 file copied*.

## 3. Comanche 3 Joystick/Throttle Configuration Files

Here are instructions for downloading specific *Comanche 3* joystick/ throttle configuration files.

### a) Instructions for: ThrustMaster™ FLCS, FLCS with WCS

- At the C:\> prompt, type *cd \TM <press the Enter>*



- At the C:\TM> prompt, type `TM` <press the Enter key>
- At the main instruction menu, select “B. Download File”.
- Click on `OK` or press the Enter key twice.
- Select `c3.b50` from the file list. Double-click your mouse or press the Enter key to open the file.
- Place the FLCS Base Mode Switch to the *Run* position, then to the *Download* position. Press Enter.
- To start download, press Button 1 (BTN S1) on the FLCS and immediately release it.
- When the transfer is complete, place the FLCS Base Mode Switch in the *Run* position and press BTN S1. When you see the message “Download Completed”, press any key to continue.
- You will be prompted as to whether or not you wish to download the FLCS setup for the Mark II WCS. If you are not using the Mark II WCS, press the N key for No.
- A red window will appear prompting you to set the red and black switches on the Mark II WCS to the Digital position. If you are using the Mark II WCS, follow the on-screen prompts and press any key when finished. If not, just press any key.

#### **b) Instructions for: ThrustMaster™ WCS, FCS with WCS**

- At the C:\> prompt, type `cd MARK2` <press the Enter>
- At the C:\MARK2> prompt, type `M2` <press the Enter key>
- Before beginning the download procedure, place both the Base Mode Switch and the Hat Mode switch (the red and black switch on the top of the Mark II WCS base) in the digital positions.
- Select B (Download file) from the C&CC main menu. The next menu requires no changes. Continue to next screen by selecting OK.\
- Scroll down the menu list and select `c3.adv` . Press the Enter key when the file is highlighted. The download procedure will begin automatically. Follow the on-screen instructions.
- Press the red Base Mode switch in the analog position, then move it forward to the Calibrate position. Press Enter.
- Press Button 1 on your Mark II WCS. This will initiate the file download. Do not touch your keyboard, Mark II WCS or FCS during the download procedure.
- Pull the throttle back. Place the red Base Mode Switch in the *Digital* position and press Button 1 on the Mark II WCS one last time.
- Once the download has finished, press any key to continue.

#### **c) Instructions for: ThrustMaster™ F-22 Pro, F-22 Pro with WCS**

- At the C:\> prompt, type `cd \TM\f22` <press the Enter>
- At the C:\TM\F22> prompt, type `f22` <press the Enter key>



- At the main instruction menu, press B on the keyboard. Press the Enter key to select option B from the Controls menu.
- At the file download display, press the Enter key twice (or click on OK). A list of downloadable files will appear on screen.
- Scroll down the list and select the `c3.f22 file`. Press the Enter key. The download is handled automatically at this point. After the download is complete, the display returns to the ThrustMaster <sup>TM</sup> C&CC.

**d) Instructions for: CH <sup>TM</sup> Pro Throttle, Fighterstick with Pro Throttle, F-16 Flightstick with Pro Throttle, combatstick with Pro Throttle, Flightstick Pro with Pro Throttle**

- At the C:\> prompt, type `cd \prothrot` <press the Enter>
- At the C:\PROTHROT> prompt, type `ptsetup` <press the Enter key>
- Select `c3.ptc` file from the file menu. Press the Enter key.
- Left-Click on “Transmit” (or press the F8 key) to download the file.

**e) Instructions for: CH <sup>TM</sup> Fighterstick**

- At the C:\> prompt, type `cd \chsetup` <press the Enter>
- At the C:\CHSETUP> prompt, type `chsetup` <press the Enter key>
- Select `c3.ptc` file from the file menu. Press the Enter key.
- Left-Click on “Transmit” (or press the F8 key) to download the file.

**f) Instructions for: CH <sup>TM</sup> Throttle (12-button)**

- At the C:\> prompt, type `cd \throttle` <press the Enter>
- At the C:\THROTTLE> prompt, type `throttle` <press the Enter key>
- Go to File. Select Open from the File menu.
- Select `c3.key` from the menu list. Press the Enter key.
- Left-Click on <Send-Recording> button to download the file.

# DOWNLOADABLE JOYSTICK/ THROTTLE FILES (Addition)

## 1. ThrustMaster™

The following joystick configurations are pre-programmed files that are included on your *Comanche 3* CD. The path leading to these files is noted with each file entry.

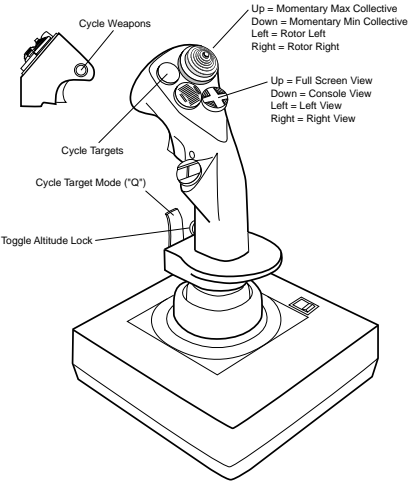

Up = Momentary Max Collective  
Down = Momentary Min Collective  
Left = Rotor Left  
Right = Rotor Right

Up = Full Screen View  
Down = Console View  
Left = Left View  
Right = Right View

### ThrustMaster™ FLCS Joystick

**Path:**  
(joystick\thrust\joystick\  
flcs\c3.b50)

and

(joystick\thrust\joystick\  
flcs\c3.m50)

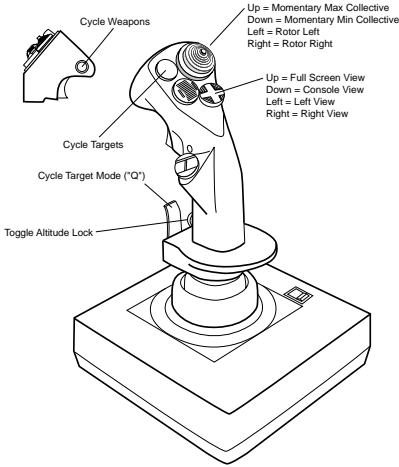

Up = Momentary Max Collective  
Down = Momentary Min Collective  
Left = Rotor Left  
Right = Rotor Right

Up = Full Screen View  
Down = Console View  
Left = Left View  
Right = Right View

### F-22 Pro Joystick

**Path:**  
(joystick\thrust\joystick\  
f22pro\c3.f22)

and

(joystick\thrust\joystick\  
f22pro\c3.M22)

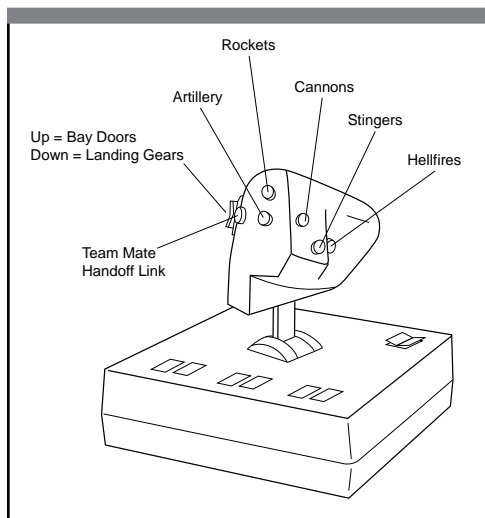

## ThrustMaster™ WCS Throttle

*Path:*  
(joystick\thrust\throttle\wsc\c3.adv)

*and*

(joystick\thrust\throttle\wsc\c3.mdf)

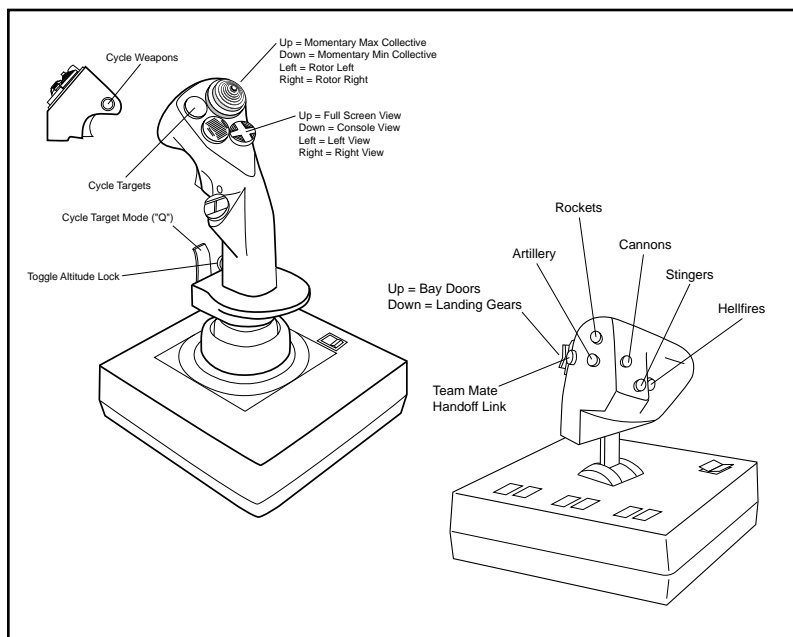

## ThrustMaster™ FLCS Joystick with WCS Throttle

*Path:*  
(joystick\thrust\both\flcswcs\c3.b50) and  
(joystick\thrust\both\flcswcs\c3.m50)

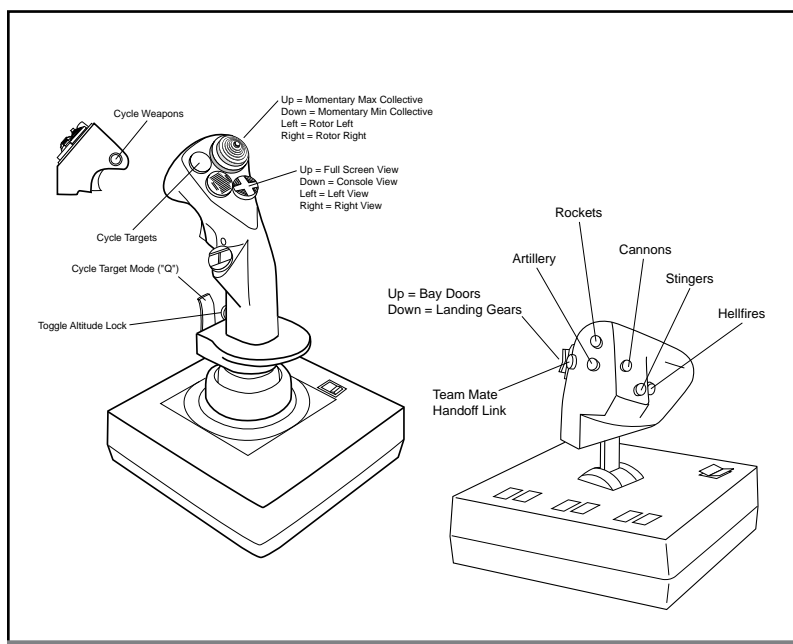

## F-22 Pro™ Joystick with WCS Throttle

**Path:**

(joystick\thrust\both\f22prwcs\c3.f22) and  
(joystick\thrust\both\f22prwcs\c3.m22)

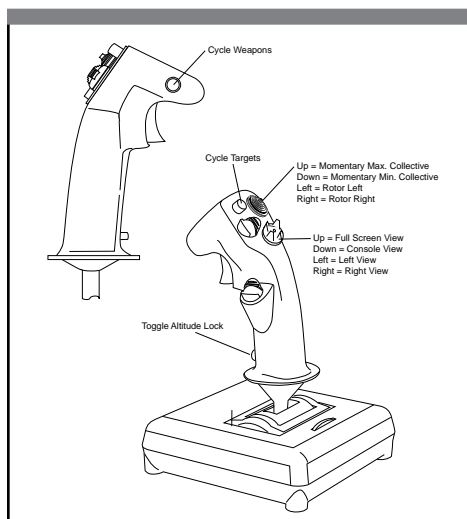

## CH™ FighterStick

**Path:**

(joystick\ch\joystick\fighter\c3.fsc)

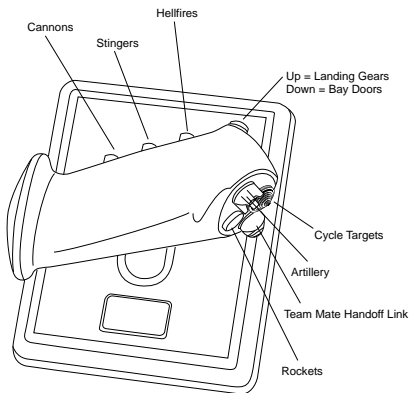

## CH™ Pro Throttle

**Path:**  
(joystick\ch\throttle\  
prothrot\c3.key)

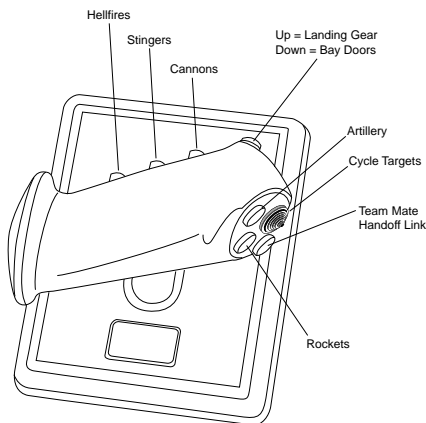

## CH™ 12-button Throttle

**Path:**  
(joystick\ch\throttle\  
12btnthr\c3.key)





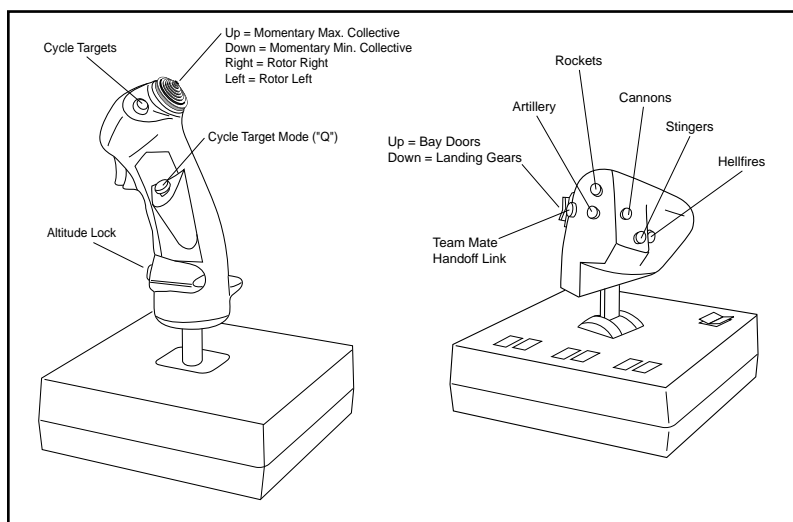

## FCS™ with WCS Throttle

**Path:**

(joystick\thrust\both\fcswcs\c3.adv) and

(joystick\thrust\both\fcswcs\c3.mdf)

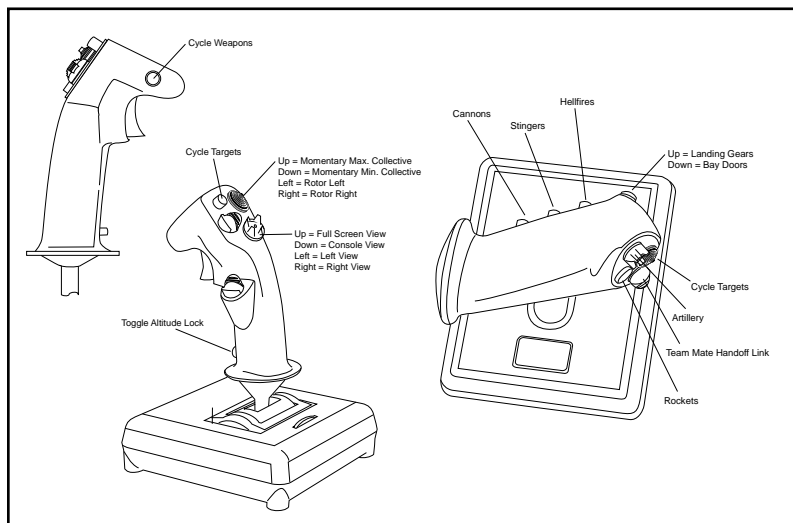

## CH™ FighterStick with Pro Throttle

**Path:**

(joystick\ch\both\fhgtrpro\c3.ptc)

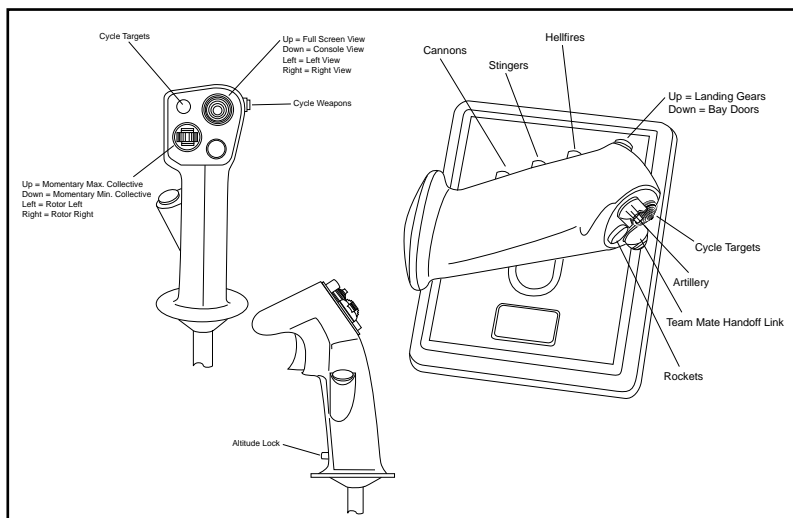

## CH™ CombatStick with Pro Throttle

**Path:**

(joystick\ch\both\cmbtpro\c3.ptc)

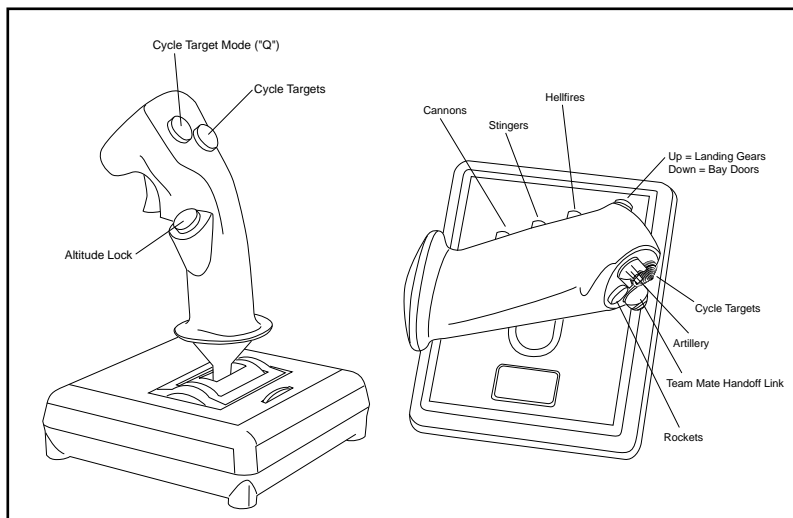

## CH™ F-16 FlightStick with Pro Throttle

**Path:**

(joystick\ch\both\f16fspro\c3.ptc)

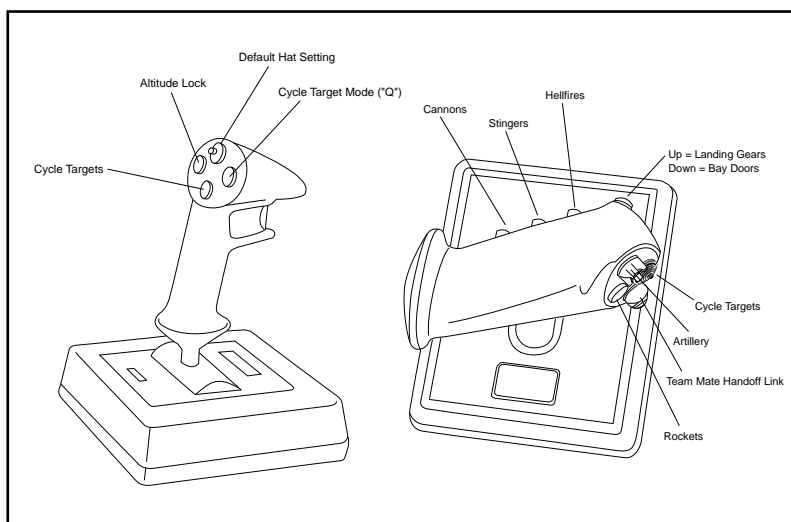

## CH™ F-16 FlightStick with Pro Throttle

Hat Switch functions are dependent upon the default settings referred to on page 24 of the game manual.

*Path:*

(joystick\ch\both\f16fspro\c3.ptc)

## NATIVE JOYSTICK/ THROTTLE NON-PROGRAMMABLE CONFIGURATIONS

These configurations are for use with non-programmable joysticks and throttles.

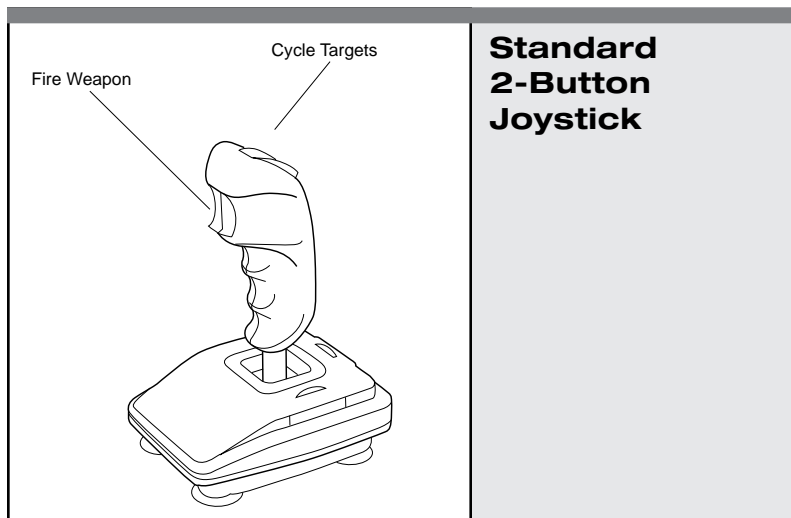

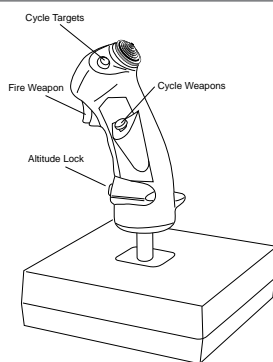

## Standard 4-Button Joystick

Hat Switch functions are dependent upon the default settings referred to on page 24 of the game manual.

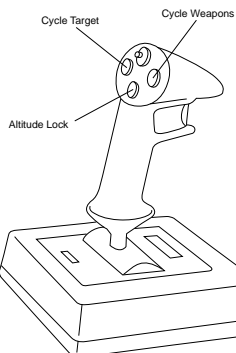

## CH™ Pro Series Joystick

Hat Switch functions are dependent upon the default settings referred to on page 24 of the game manual.

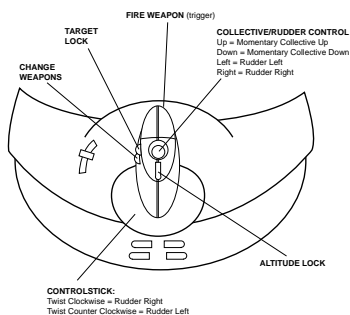

## SideWinder™ Pro Joystick

Hat Switch functions are dependent upon the default settings referred to on page 24 of the game manual.

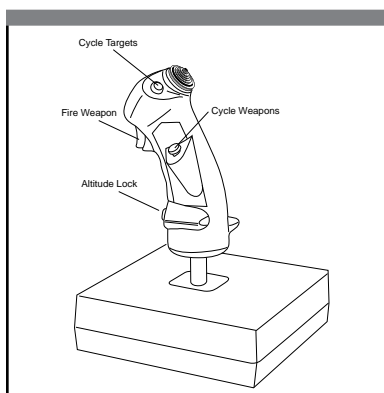

## ThrustMaster™ FCS Joystick

Hat Switch functions are dependent upon the default settings referred to on page 24 of the game manual.

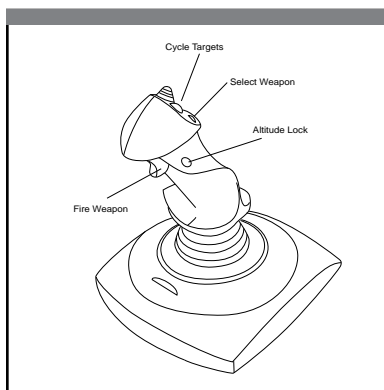

## Wingman Extreme™ Joystick

Hat Switch functions are dependent upon the default settings referred to on page 24 of the game manual.

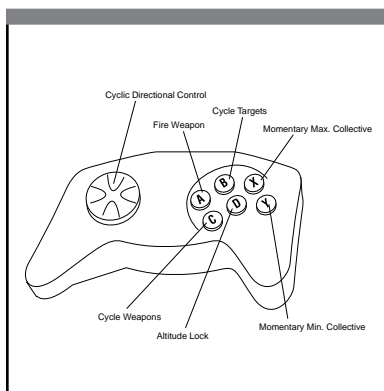

## CH™ Gamepad

## Credits

General MIDI timbres for Yamaha OPL-2- and OPL-3- based sound cards were produced by the Fat Man™ and developed by K. Weston Phelan and George Allistair Sanger. Copyright 1993, The Fat Man™.